



City of  
**Peterborough**

---

**To:** Members of the Arenas Parks and Recreation Advisory Committee

**From:** Rob McAulay, Director, Recreation and Parks Services

**Meeting Date:** August 13, 2024

**Report:** Bonnerworth Park Presentation, Report APRAC24-010

---

## **Subject**

A report to present the draft design of the Bonnerworth Park Redevelopment project and seek input from the Arenas, Parks, and Recreation Advisory Committee (APRAC) and the Accessibility Advisory Committee (AAC).

## **Recommendations**

That the Arenas, Park, and Recreation Advisory Committee (APRAC) approve the recommendations outlined in Report APRAC24-010, dated August 13, 2024, of the Director, Recreation and Park Services Division as follows:

- a) That a presentation on the design of the Bonnerworth Park Redevelopment project be received for information; and
- b) That members of the Arenas, Parks, and Recreation Advisory Committee provide feedback on the proposed design for Bonnerworth Park; and
- c) That members of the Accessibility Advisory Committee provide feedback on the proposed design for Bonnerworth Park and advise on how to incorporate accessibility into the project. At a minimum, advise on the following AAC consultation requirements of the Integrated Accessibility Standards Regulation:
  - i. Slope of recreational trails and the need for ramps, rest areas, passing areas, viewing areas, amenities, and any other related feature;

- ii. Design and placement of rest areas along the exterior paths of travel (walkways); and
- iii. Needs of children and caregivers with various disabilities for outdoor play spaces.

## Executive Summary

- The City of Peterborough is planning a park redevelopment project of Bonnerworth Park.
- The purpose of the presentation is to give the members of the Arenas, Park and Recreation Advisory Committee and members of the Accessibility Advisory Committee an opportunity to provide input on the proposed design, identify barriers and use an accessibility and inclusion lens to advise on how to make the project more accessible for people with disabilities.

## Background

The City of Peterborough is taking a strategic approach to park planning, including the most recent Parks and Outdoor Recreation Facilities Study, which included engagement with residents and stakeholder groups. Council approved the plan in fall of 2023. The first project to come from that plan is investments in two centrally located parks on main arterial roads with good access to transit routes that were identified as recreation hubs serving the broader community, not just the immediately adjacent neighbourhoods.

For Bonnerworth Park, the outdoor recreation facility study recommended the city invest in expanding the skateboard park, creating a new bike pump track, and adding pickleball courts. The tennis courts at Bonnerworth Park will be removed and new tennis courts will be built at Knights of Columbus Park to ensure no loss of total tennis courts in the city.

The City's 2024 to 2028 Accessibility Plan identifies the Bonnerworth Park redevelopment project as a priority under the plan's short-term road map (2024 to 2028 priorities). The priority identified is intended to address a general lack of walkway networks in parks with an action plan to incorporate walkways and/or multi-use paths into new parks and park rejuvenation projects, including connecting walkways to the municipal sidewalk network and all site amenities (i.e., accessible benches, tables, shade features). The plan also identifies a lack of accessible site features and play equipment in many parks, with an action plan to implement the park development standards of the 2019 Municipal Parks and Open Space Study and Urban Design Guidelines into newly developed parks and park rejuvenation projects, where possible, including pedestrian scale lighting, accessible site furnishings, such as seating with arm rests and back rests and walkway connections to waste/recycle bins.

## Strategic Plan

Strategic Pillar: Community & Well-being

Strategic Initiative: “Encourage our neighbourhoods to be safe, diverse, accessible, and affordable across all ages, incomes, and abilities.”

AAC recommendations focus on how to make parks more accessible for persons with disabilities.

## Engagement and Consultation

In addition to the previous input from community consultation and stakeholder groups, background studies have been completed to inform the detailed design of the project including traffic, parking, and noise mitigation.

Members of the Arenas, Parks, and Recreation Advisory Committee are being asked to provide feedback on the draft concept plan.

Members of the Accessibility Advisory Committee are being asked to provide feedback on the proposed design for Bonnerworth Park and advise on how to incorporate accessibility into the project

## Budget and Financial Implications

There are no budgetary or financial implications associated with the recommendations. Council approved the \$2-million budget for the first phase of the Bonnerworth project in the City’s 2024 Budget in December 2023, including a \$2.4 million pre-commitment for the second phase of the project in 2025.

The draft plan features elements included within the projected budget and project scope, including the expanded skateboard park, the specialized bike pump track, the new pickleball courts, and associated landscaping. The features included within the final plan will align with the approved council budget.

## Attachments

Appendix A: Bonnerworth Park Redevelopment Concept Plan

Submitted by,

Rob McAulay  
Director, Recreation and Park Services Division

**Contact Name:**

Sean Nailer

Parks and Recreation Project Manager

Phone: 705-742-7777 Ext. 1829

Toll Free: 1-855-738-3755

Email: [snailer@peterborough.ca](mailto:snailer@peterborough.ca)

Mark Buffone

Accessibility Compliance Specialist

Phone: 705-742-7777 Ext. 1630

Toll Free: 1-855-738-3755

Email: [mbuffone@peterborough.ca](mailto:mbuffone@peterborough.ca)

# BONNERWORTH PARK REDEVELOPMENT

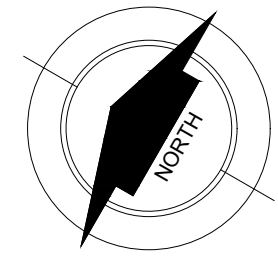

1:600m

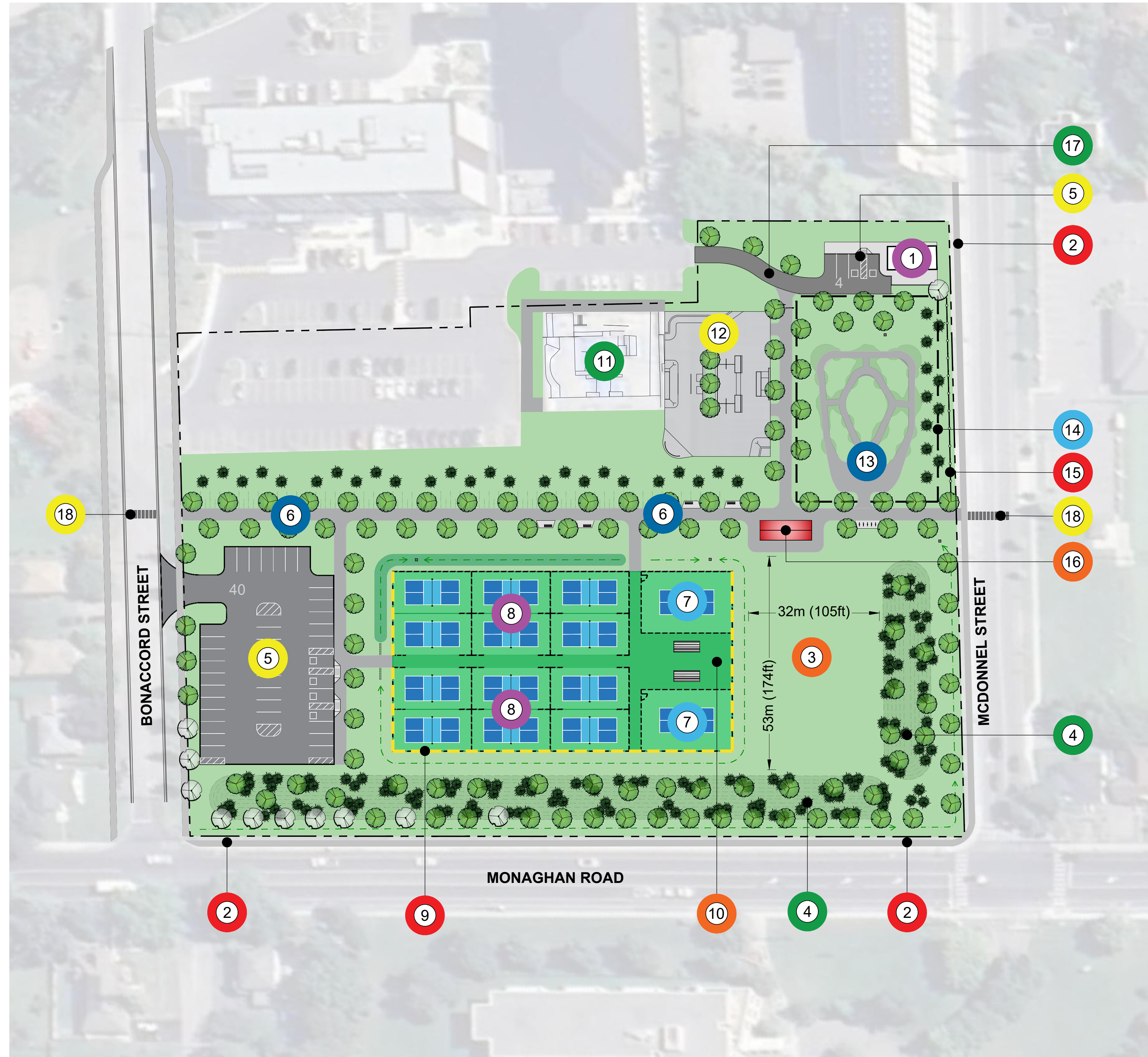

## KEYS

- |   |  |    |  |
|---|--|----|--|
| 1 | EXISTING WASHROOM BUILDING                           | 10 | PROPOSED OPEN PLAZA (+/-315m <sup>2</sup> )                |
| 2 | EXISTING MUNICIPAL SIDEWALK                          | 11 | EXISTING SKATEPARK   |
| 3 | PROPOSED OPEN LAWN AREA                              | 12 | PROPOSED SKATEPARK EXPANSION                               |
| 4 | PROPOSED LANDSCAPED BERMS                            | 13 | PROPOSED PUMP TRACK  |
| 5 | PROPOSED VEHICLE PARKING<br>TOTAL PARKING STALLS: 44 | 14 | LIMIT OF SLOPE<br>TRANSITIONS REQUIRED<br>FOR PUMPTRACK    |
| 6 | PROPOSED WALKWAY CONNECTIONS                         | 15 | PROPOSED DECORATIVE<br>METAL FENCE                         |
| 7 | PROPOSED ACCESSIBLE PLAY<br>PICKLEBALL COURTS (2)    | 16 | PROPOSED SHADE SHELTER<br>WITH GATHERING TABLES            |
| 8 | PROPOSED STANDARD PLAY<br>PICKLEBALL COURTS (12)     | 17 | PROPOSED MAINTENANCE<br>AND VEHICLE ACCESS<br>ROUTE        |
| 9 | PROPOSED ACOUSTIC SCREEN /<br>NOISE BARRIER          | 18 | PROPOSED CROSSWALK<br>CONNECTIONS (REFER TO<br>NOTE BELOW) |

## LEGEND

- |  |  |  |                                     |
|--|--|--|-------------------------------------|
|  | EXISTING TREES                               |  | ENHANCED VEGETATED SWALE            |
|  | PROPOSED DECIDUOUS TREES                     |  | SOD                                 |
|  | PROPOSED CONIFEROUS TREES                    |  | ASPHALT PAVING (WALKWAYS)           |
|  | PROPOSED BIKE RINGS ON<br>CONCRETE BASE      |  | ASPHALT PAVING<br>(PARKING LOT)     |
|  | PROPOSED BENCH ON CONCRETE<br>BASE           |  | CONCRETE PAVING                     |
|  | PROPOSED LOCATION FOR<br>SPECTATOR BLEACHERS |  | SWALES                              |
|  |  |  | BLACK VINYL CHAIN<br>LINK FENCE     |
|  |  |  | ACOUSTIC SCREENS /<br>NOISE BARRIER |

## NOTE:

BONACCORD STREET ROAD RECONSTRUCTION INCLUDING SIDEWALKS, CURBS, AND PEDESTRIAN CROSSING, IF WARRANTED, IS NOT INCLUDED IN THE BONNERWORTH PARK DEVELOPMENT PROJECT. BONACCORD STREET RECONSTRUCTION WORKS ILLUSTRATED ON THIS PLAN ARE CONCEPTUAL ONLY, AND IS SUBJECT TO FUTURE BUDGET APPROVALS AND PUBLIC CONSULTATION.