

Kenner/Roger Neilson
 School Area Speed Limit
 Reduction

30 km/h Speed Limit	Community Safety Zone
40 km/h Speed Limit	

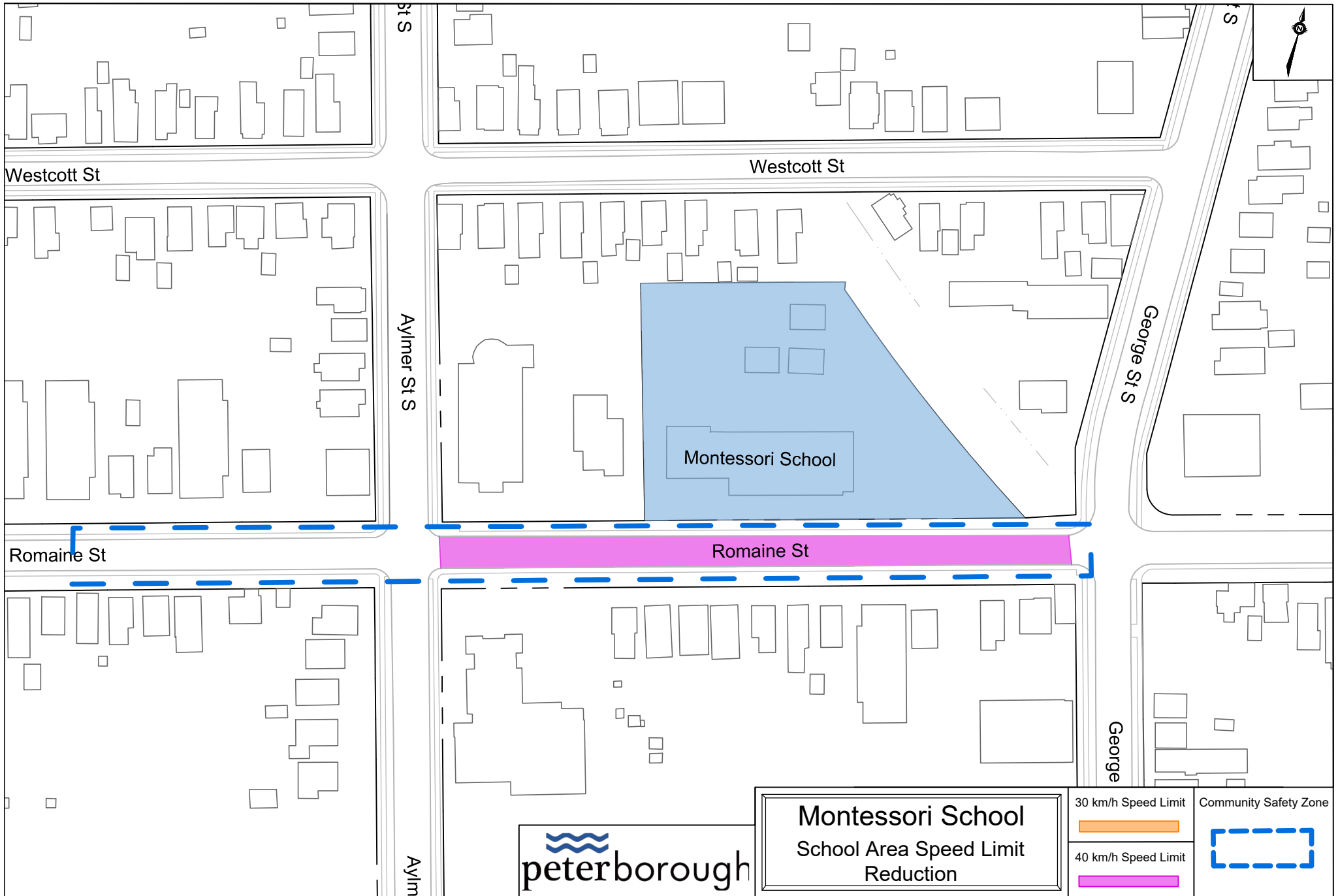

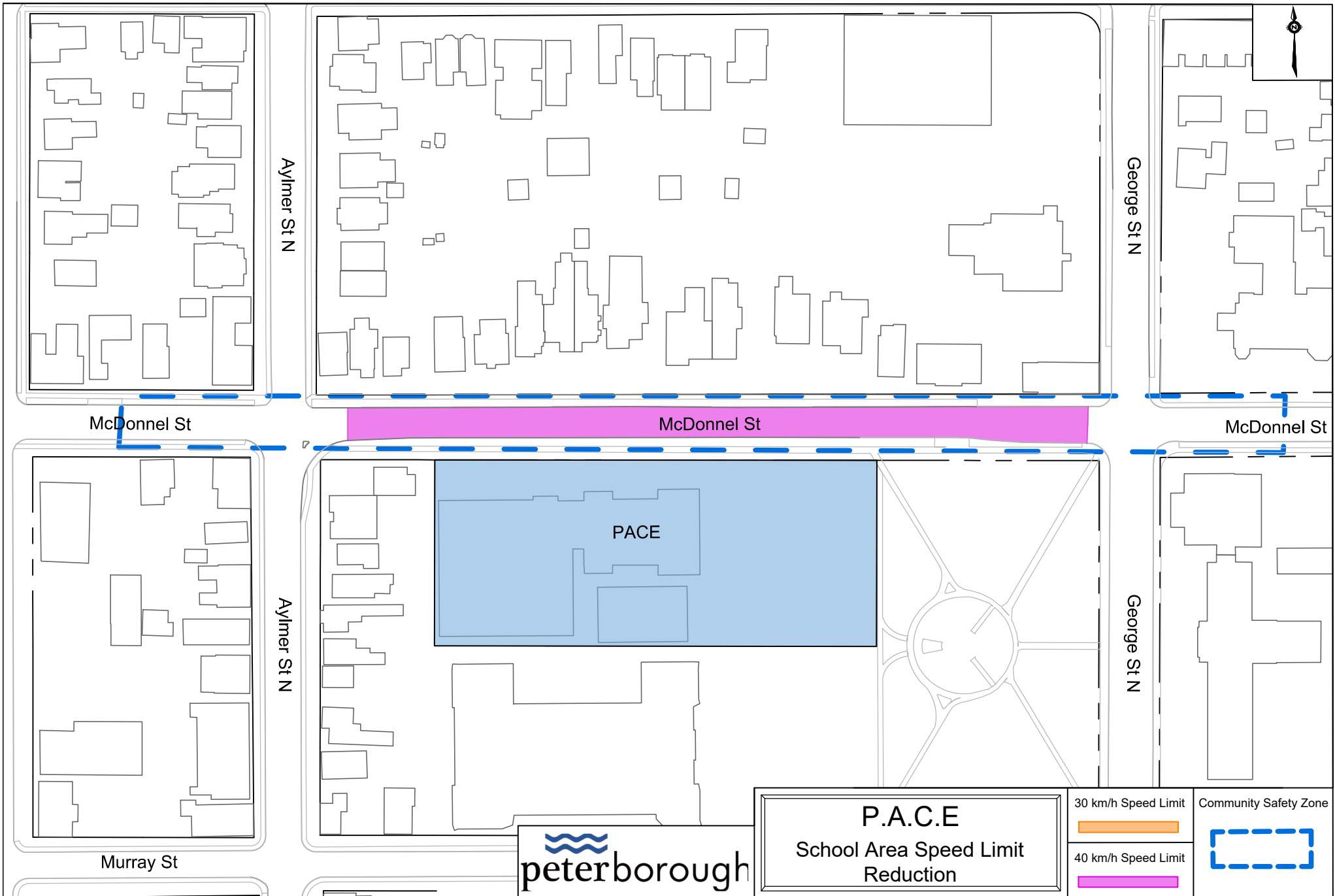



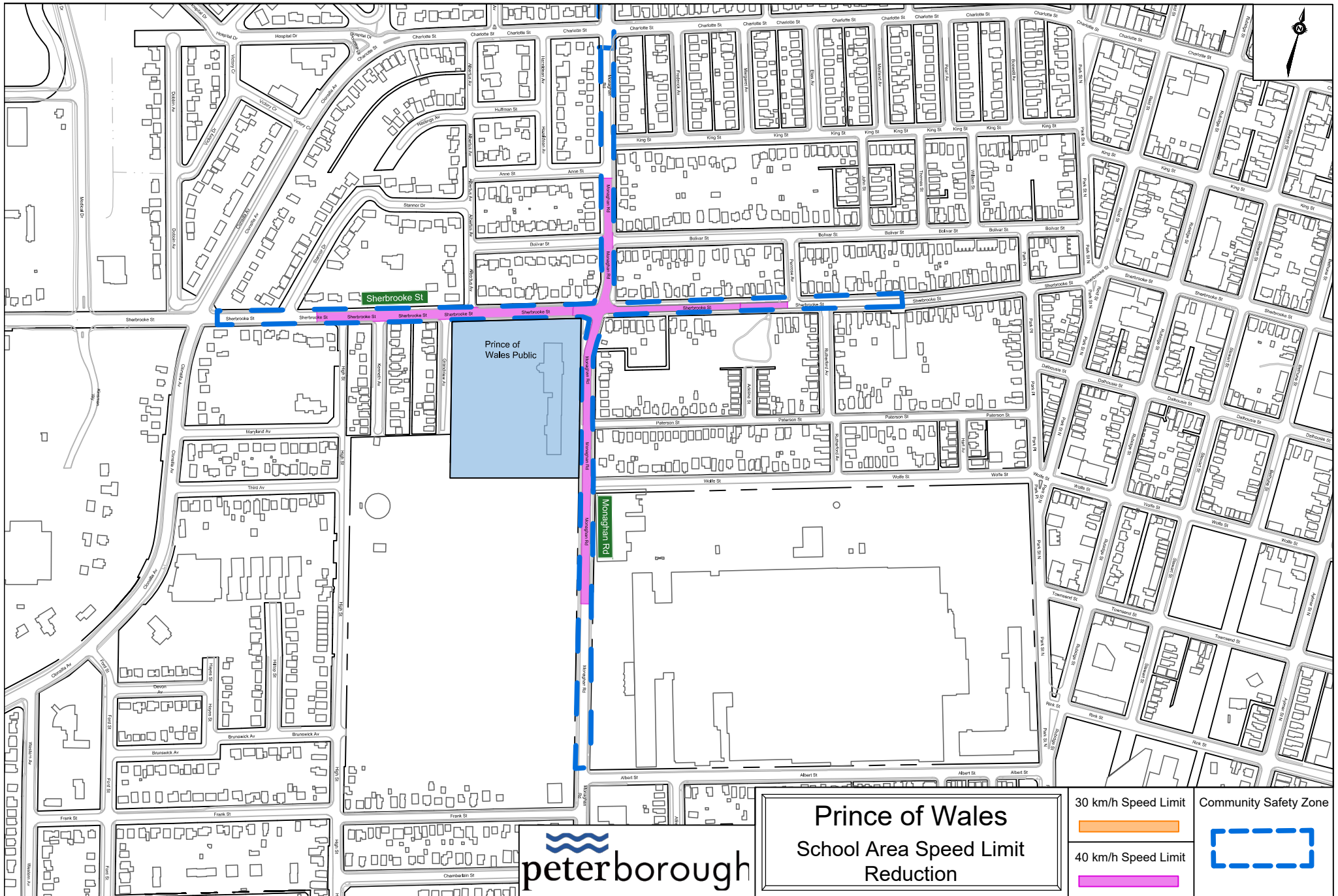

Prince of Wales
 School Area Speed Limit
 Reduction

30 km/h Speed Limit	Community Safety Zone
40 km/h Speed Limit	



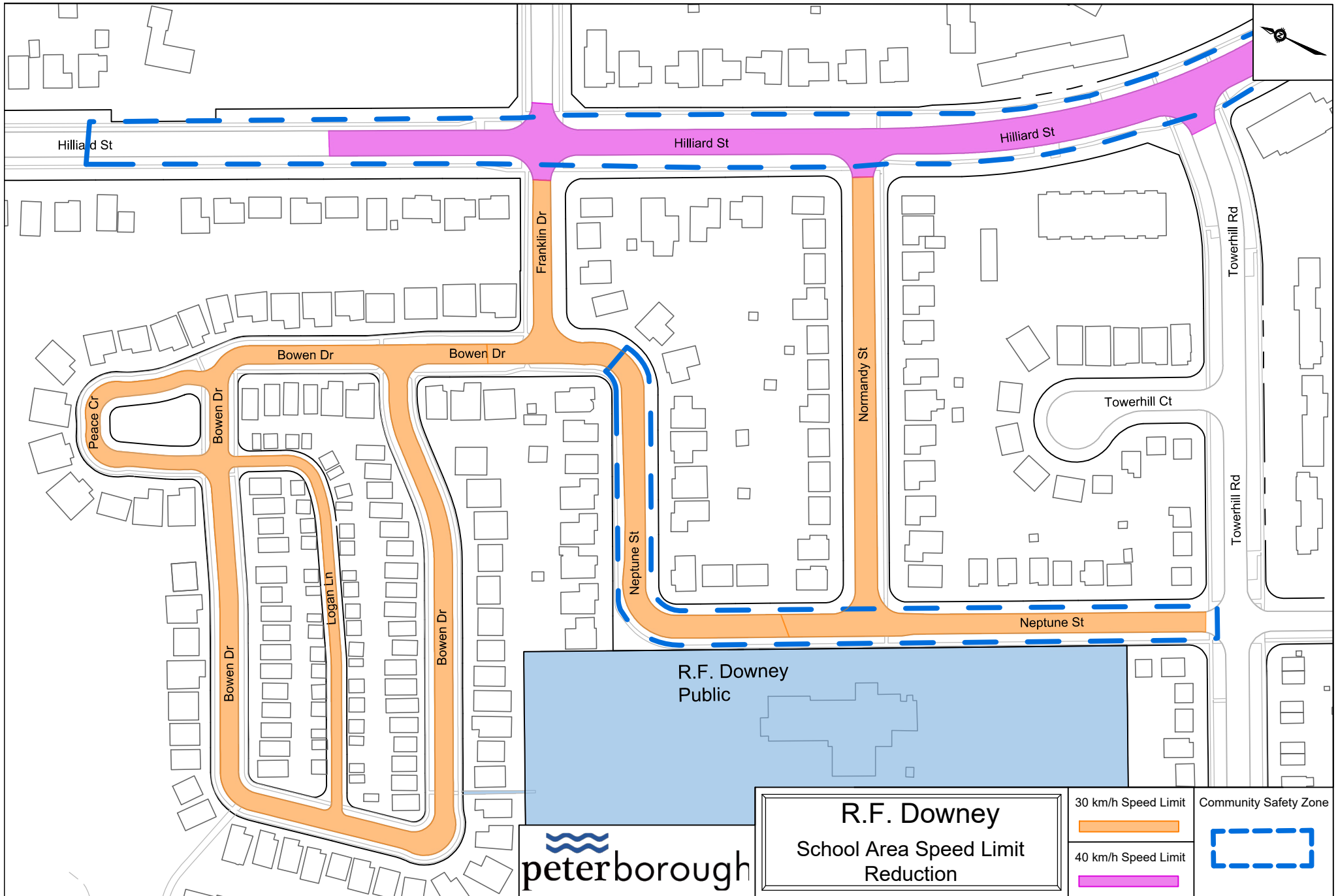

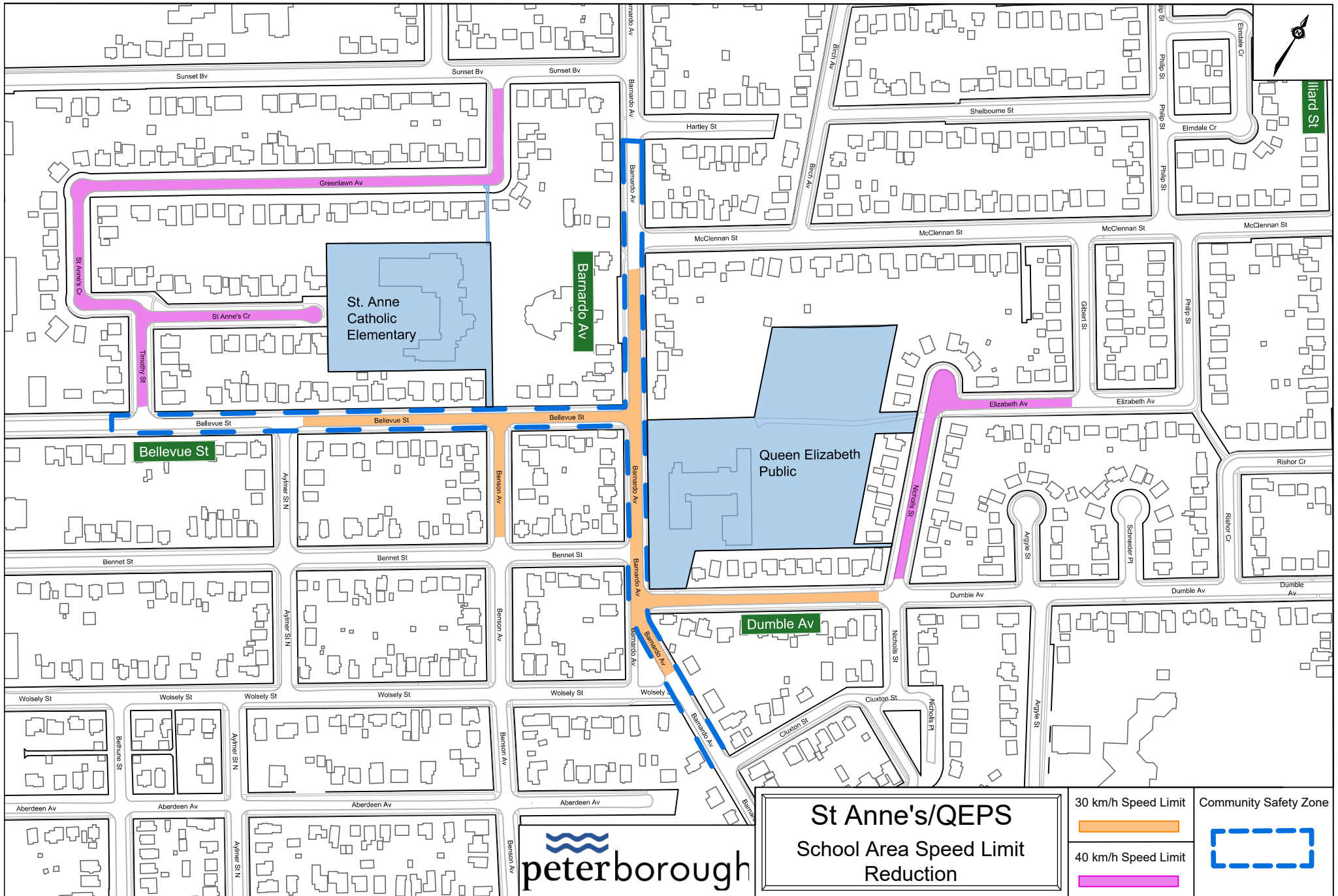

St Anne's/QEPS
 School Area Speed Limit
 Reduction

30 km/h Speed Limit	Community Safety Zone
40 km/h Speed Limit	

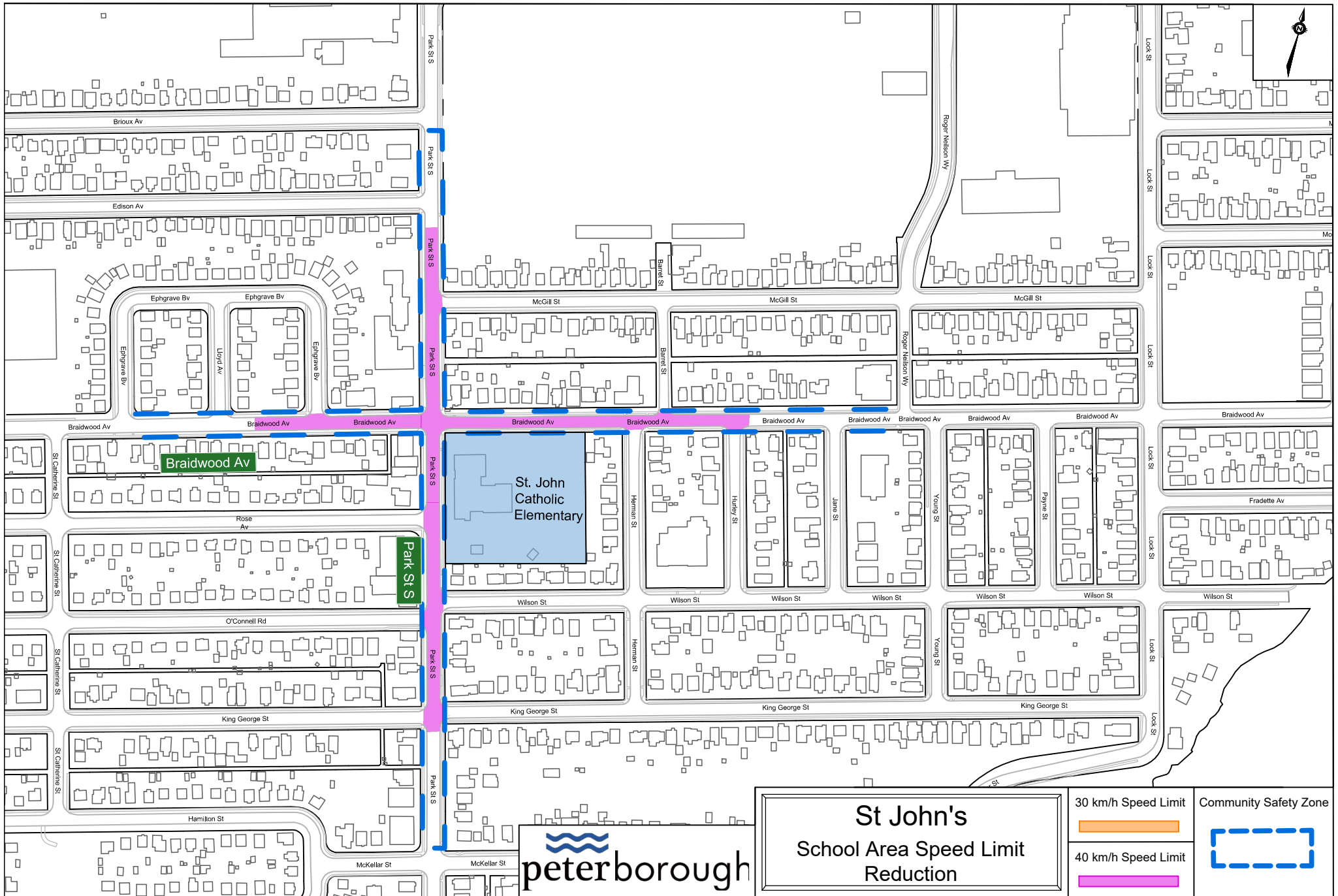

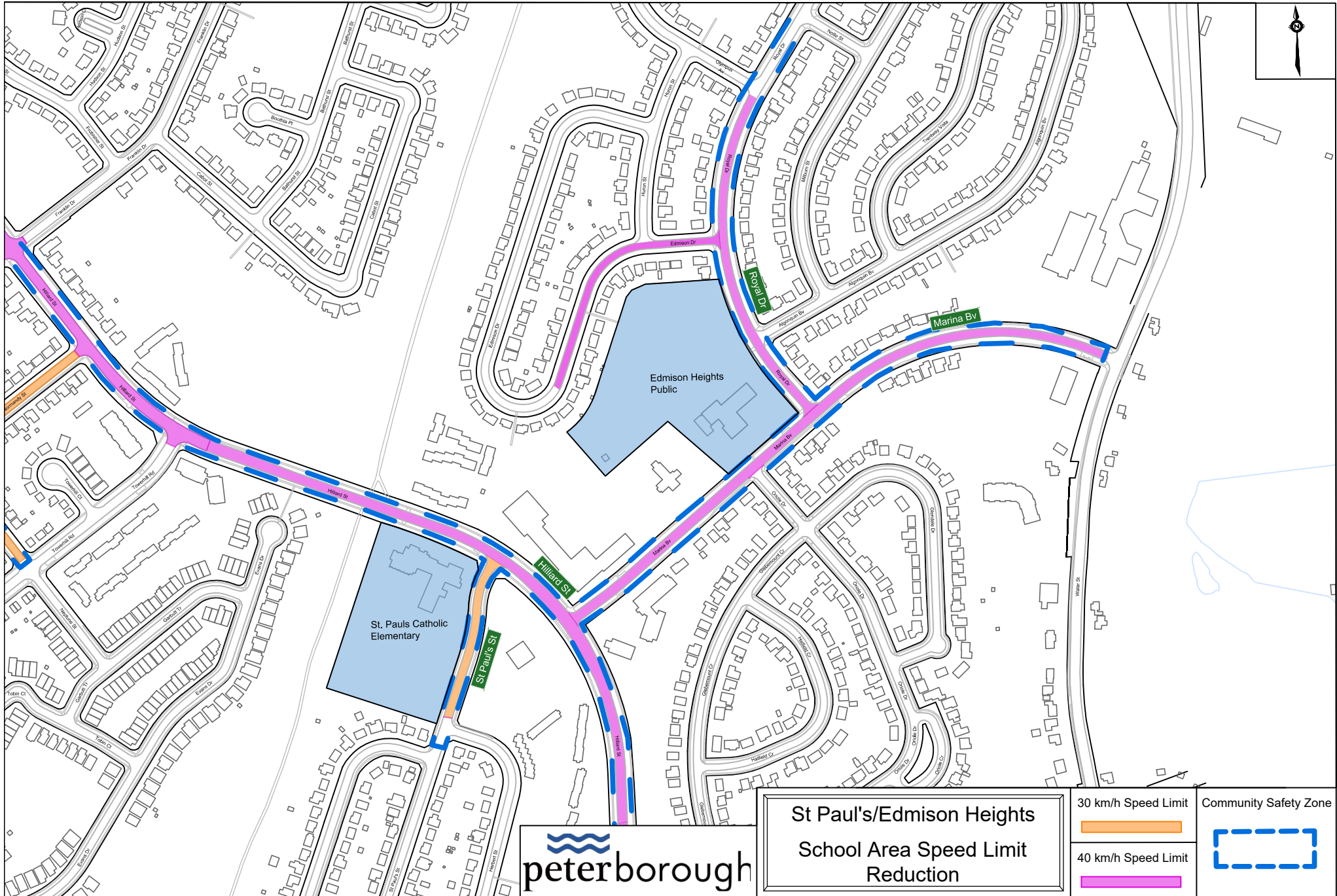

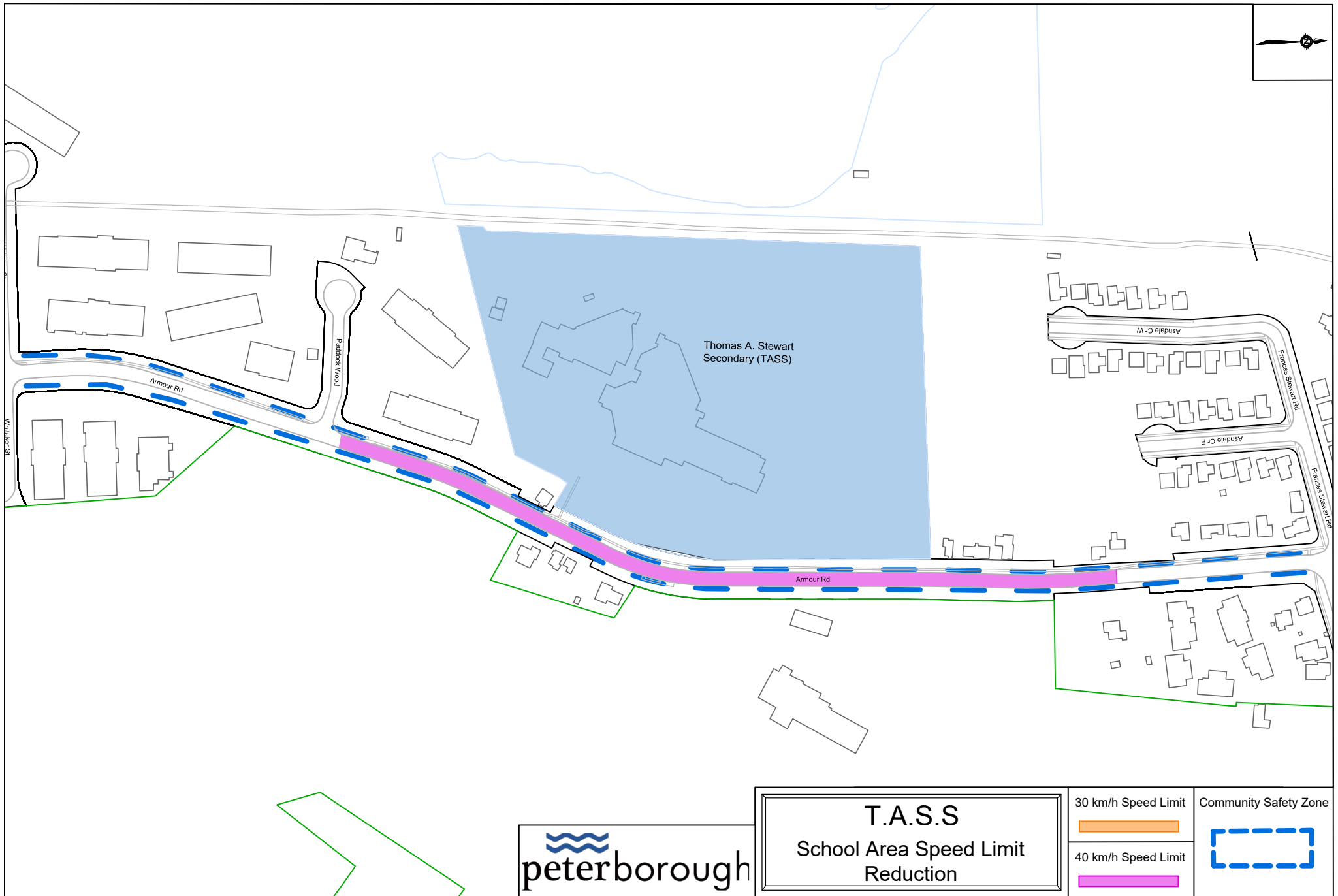

T.A.S.S
School Area Speed Limit
Reduction

30 km/h Speed Limit	
40 km/h Speed Limit	

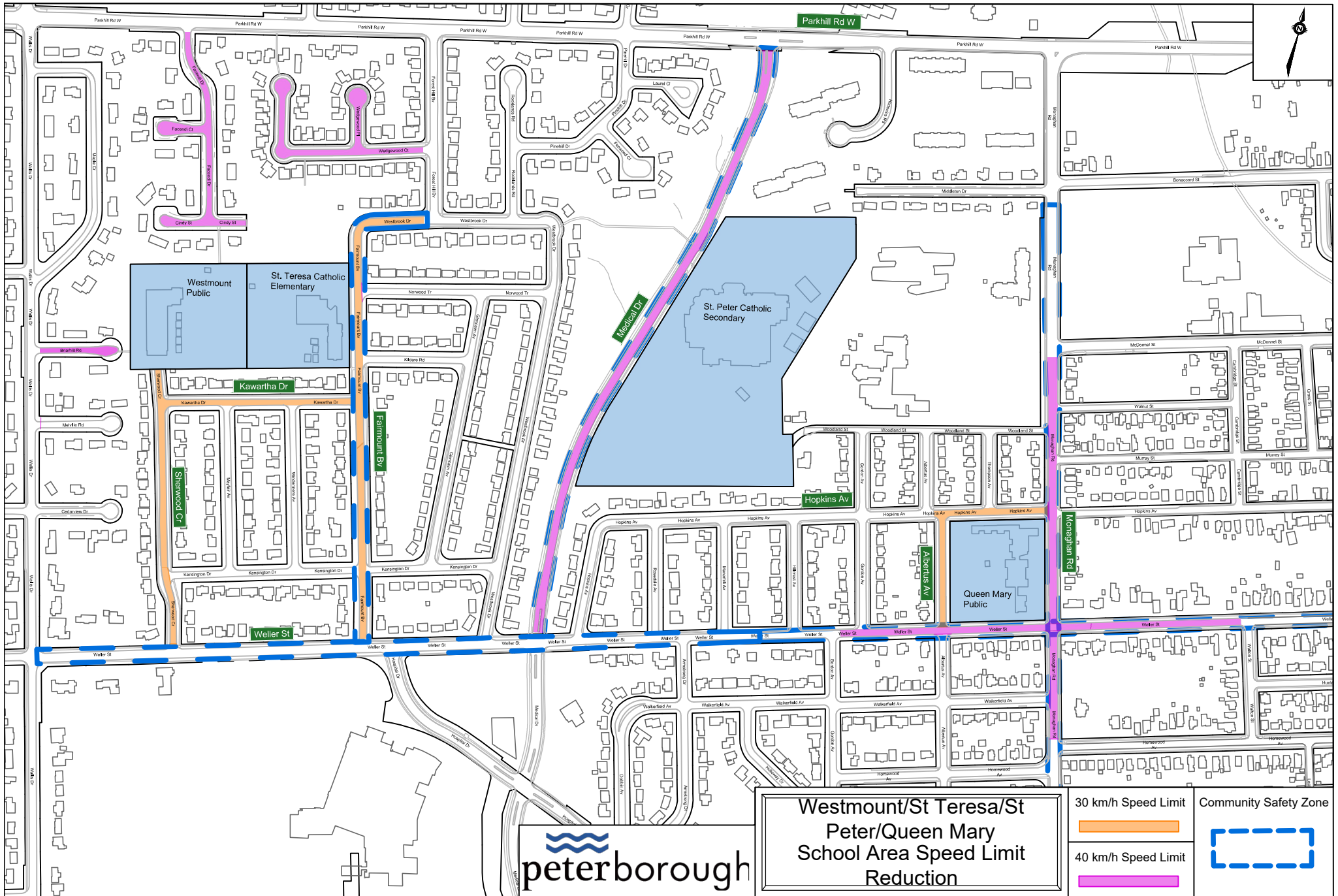

Westmount/St Teresa/St
 Peter/Queen Mary
 School Area Speed Limit
 Reduction

30 km/h Speed Limit	Community Safety Zone
40 km/h Speed Limit	

Appendix B – Report IPSENG23-014



The Corporation of the City of Peterborough

By-Law Number 20-[Clerk's Office will assign the number]

Being a By-law to Regulate Speed Limits on certain streets in the City of Peterborough

Whereas Section 128 of the **Highway Traffic Act, R.S.O. 1990, c. H.8** permits the Council of a municipality to prescribe, by by-law, a rate of speed of either greater or less than fifty (50) kilometres per hour;

Now Therefore, The Corporation of the City of Peterborough by the Council thereof hereby enacts as follows:

1) Speed Limits

- a) No person shall drive a motor vehicle at a rate of speed greater than sixty (60) kilometres per hour:

Highway	Between
Water Street	Carnegie Avenue to the north City Limit
Lansdowne Street East	100 metres east of Willowcreek Boulevard to the east City Limit
The Parkway	Clonsilla Avenue to the south City Limit
Sir Sandford Fleming Drive	The Parkway to the west City Limit

- b) No person shall drive a motor vehicle at a rate of speed greater than forty (40) kilometres per hour:

Highway	Between
Armour Road	Paddock Wood to 160m south of Frances Stewart Road; Douro Street to 115m north of St. Luke's Avenue
Bellaire Street	Shirley Avenue to the westerly end of the roadway
Bensfort Road	River Road South to Gutherie Drive
Braidwood Avenue	Lloyd Avenue to Hurley Street
Brealey Drive	220m north of Kawartha Heights Boulevard to 130m north of Sherbrooke Street
Briarhill Road	Entire Roadway
Chamberlain Street	Goodfellow Road to Western Avenue
Edgewater Boulevard	Maria Street to Wallace Street

Appendix B – Report IPSENG23-014

Edmison Drive	Royal Drive to 200m southwest of Huron Street
Elizabeth Avenue	Nicholls Street to Gilbert Street
Erskine Avenue	McKellar Street to Cameron Street
Glenforest Boulevard	Woodglade Boulevard to Tamblin Way
Goodfellow Road	Lansdowne Street West to Chamberlain Street
High Street	Sherbrooke Street to Chamberlain Street
Highland Road	Fairbairn Street to Highland Court; Applegrove Avenue to Chemong Road
Hilliard Street	Rishor Crescent to 90m north of Franklin Drive
Humber Road	Saugeen Crescent to the easterly end of the roadway
Hunter Street East	Burnham Street to Ashburnham Drive
Kawartha Heights Boulevard	Springbrook Drive to Lansdowne Street West
Marina Boulevard	Entire Roadway
McDonnel Street	Aylmer Street North to George Street North
Medical Drive	Parkhill Road West to Weller Street
Monaghan Road	McDonnel Street to Homewood Avenue (north leg); Anne Street to 150m south of Wolfe Street; King George Street to Cameron Street
Nicholls Street	Dumble Avenue to Elizabeth Avenue
Otonabee Drive	Bensfort Road to Finchurst Road
Park Street South	Edison Avenue to King George Street
River Road South	Southlawn Drive to Bensfort Road
Romaine Street	Aylmer Street to George Street South
Royal Drive	Marina Boulevard to Olympus Avenue (south leg)
Sherbrooke Street	175m west of Denure Drive to the west City Limit; Hywood Road to 210m west of Glenforest Boulevard; Stannor Drive to Penrose Avenue
Weller Street	Gordon Avenue (west leg) to Walton Street
Woodglade Boulevard	Sherbrooke Street to Glenforest Boulevard

- c) No person shall drive a motor vehicle at a rate of speed greater than thirty (30) kilometres per hour:

Highway	Between
Albertus Avenue	Weller Street to Hopkins Avenue
Barnardo Avenue	Wolsely Street to McClennan Street

Appendix B – Report IPSENG23-014

Bellevue Street	Aylmer Street North to Barnardo Avenue
Bethune Street	Wolfe Street to Dublin Street
Benson Avenue	Bellevue Street to Bennet Street
Donegal Street	Bellevue Street to Highland Road
Dumble Avenue	Barnardo Avenue to Nicholls Street
Erskine Avenue	Crawford Drive to Cameron Street
Fairmount Boulevard	Entire Roadway
Gillespie Avenue	Entire Roadway
Hewitt Drive	Entire Roadway
Highland Court	Entire Roadway
Highland Road	Highland Court to Applegrove Avenue
Hopkins Avenue	Monaghan Road to Albertus Avenue
Kawartha Drive	Entire Roadway
Langton Street	Hilliard Street to 250m east of Hilliard Street
Marsdale Drive	Hargrove Trail to Idyllwood Crescent (northeast leg)
Museum Drive	Entire Roadway
Sherwood Crescent	Entire Roadway
St. Mary's Street	Goodfellow Road to Western Avenue
St. Patrick's Road	Entire Roadway
St. Paul's Street	Hilliard Street to Herbert Street
Westbrook Drive	Forest Hill Boulevard to Fairmount Boulevard
Wightman Avenue	Entire Roadway

2) When any designated area in Column 1 of Section 2.0 in this By-law is marked in compliance with the regulations made under the Highway Traffic Act, the maximum rate of speed thereon shall be the rate of speed prescribed in Column 2

a) In the event there is a conflict between the Rate of Speed in Section 2.0 and 1.0, the maximum rate of speed set out in Section 1.0 shall apply.

Column 1	Column 2
Neighbourhood Boundaries	Rate of Speed
Cherryhill Road, Kawartha Heights Boulevard, Lansdowne Street, Applewood Court	30 km/h
Hilliard Street, Towerhill Road, Bowen Drive, Peace Crescent	30 km/h

Appendix B – Report IPSENG23-014

Hunter Street East, Rogers Street, Sophia Street, Burnham Street	30 km/h
Maniece Avenue, Television Road, Tudor Crescent, Meadowview Road	40 km/h
Parkhill Road West, Forest Hill Boulevard, Cindy Street, Maple Crescent	40 km/h
Sunset Boulevard, Barnardo Avenue, Bellevue Street, Chemong Road	40 km/h

- 3) Subject to sections 4 and 5 By-Law 16-116 is repealed and this by-law shall come into force and effect upon the date approved by Council of the Corporation of the City of Peterborough.
- 4) The repeal of By-Law 16-116 does not affect:
- a) Its previous operation;
 - b) An obligation or liability that came into existence under it;
 - c) An offence committed contrary to it, penalty or fine imposed in connection with the offence;
 - d) An investigation, proceeding, or remedy in respect of an obligation or liability describe in subparagraph (b).
- 5) An investigation, proceeding, or remedy described in paragraph 4(d) may be commenced, continued, and enforced as if By-Law 16-116 had not been repealed, provided that at the time of the offence, obligation or liability first arose the signage was in accordance with By-Law 16-116.

By-law passed this 26th day of June, 2023.

Jeff Leal, Mayor

John Kennedy, City Clerk

Appendix C – Report IPSENG23-014



The Corporation of the City of Peterborough

By-Law Number 20-[Clerk's Office will assign the number]

Being a By-law to Amend By-Law 13-098 being a By-Law to Designate a Part of a Highway in the City of Peterborough as a Community Safety Zone.

Now Therefore, The Corporation of the City of Peterborough by the Council thereof hereby enacts as follows:

1. That Schedule A of By-Law 13-098 be amended by removing the following:
 1. Weller Street from Park Street to Wallis Drive.
2. That Schedule A of By-Law 13-098 be amended by adding the following:

Highway	Between
Applewood Crescent	Applewood Court to Kawartha Heights Boulevard
Armour Road	Whitaker Street to Frances Stewart Road; Munroe Avenue to St. Luke's Avenue
Barnardo Avenue	Hartley Street to Cluxton Street
Bellevue Street	Timothy Street to Barnardo Avenue
Bensfort Road	River Road South to Guthrie Drive
Braidwood Avenue	Ephgrave Boulevard (west leg) to Roger Neilson Way
Brealey Drive	Kawartha Heights Boulevard to 250m north of Sherbrooke Street
Clonsilla Avenue	300m north of Lansdowne Street West to Lansdowne Street West
Erskine Avenue	Entire Roadway
Fairmount Boulevard	Entire Roadway
Gillespie Avenue	Entire Roadway
Glenforest Boulevard	Woodglade Boulevard to Wildlark Drive
Goodfellow Road	Clonsilla Avenue to Lansdowne Street West
Highland Road	Entire Roadway
Hilliard Street	Rishor Crescent to 200m north of Franklin Drive
Hunter Street East	Entire Roadway
Kawartha Heights Boulevard	Lansdowne Street West to 80m north of Springbrook Drive

Appendix C – Report IPSENG23-014

Lansdowne Street West	Village Crescent to 300m east of Clonsilla Avenue
Marina Boulevard	Entire Roadway
Mark Street	Hunter Street East to Sophia Street
Marsdale Drive	Tudor Crescent to Foxmeadow Road
McDonnel Street	40m east of George Street North to 40m west of Aylmer Street North
Medical Drive	Parkhill Road West to Weller Street
Monaghan Road	Middleton Drive to Albert Street; Bellaire Street to Hawley Street
Neptune Street	Towerhill Road to Franklin Drive
Otonabee Drive	Bensfort Road to Crystal Drive
Park Street South	Brioux Avenue to McKellar Street
River Road South	Southlawn Drive to Bensfort Road
Robinson Street	Entire Roadway
Romaine Street	George Street South to 100m west of Aylmer Street South
Royal Drive	Notte Street to Marina Boulevard
Sherbrooke Street	Clonsilla Avenue to 100m east of Rutherford Avenue
Spillsbury Drive	Lansdowne Street West to 60m south of Lansdowne Street West
St. Mary's Street	Goodfellow Road to Ford Street
St. Paul's Street	Barnardo Avenue to Hilliard Street
Weller Street	Park Street to Wallis Drive
Westbrook Drive	Fairmount Boulevard to Forest Hill Boulevard
Wightman Avenue	Entire Roadway
Woodglade Boulevard	Ridgewood Road to Glenforest Boulevard

By-law passed this 31st day of August, 2023.

Jeff Leal, Mayor

John Kennedy, City Clerk

Appendix D – Report IPSENG23-014



City of
Peterborough

The Corporation of the City of Peterborough

By-Law Number 20-[Clerk's Office will assign the number]

Being a By-law to Amend By-Law 09-136 being a By-Law for the Regulation of Parking

Now Therefore, The Corporation of the City of Peterborough by the Council thereof hereby enacts as follows:

1. That By-Law 09-136, Section 2.0 Definitions be amended by adding the following:

VERTICAL CENTERLINE TREATMENTS – mean part of a HIGHWAY designated by an AUTHORIZED SIGN installed in the center of the HIGHWAY.

2. That By-Law 09-136, Section 4.0 General Parking and Stopping PROHIBITIONS – OTHER REGULATIONS be amended by adding the following:

PARKING Near VERTICAL CENTERLINE TREATMENTS: Where an AUTHORIZED SIGN to that effect is displayed on the center line of a HIGHWAY, no person shall STOP a VEHICLE on a HIGHWAY any time or between the hours and on the days set out on the OFFICIAL SIGN, on either side of the HIGHWAY

By-law passed this day of , 2023.

Jeff Leal, Mayor

John Kennedy, City Clerk