

**Peterborough County/City Waste Management  
Site Liaison Committee Meeting  
Tuesday, July 13, 2010 at Stewart Hall**

---

**In attendance:**

- Committee Members:** Reeve Dave Nelson - Chairman, Mayor Paul Ayotte, Deputy Reeve Paul Heath, Roy Craft, Steve St. Jean
- Staff Members:** Chris Bradley and Laurie Westaway – County of Peterborough, Melanie Kawalec and Craig Simmons – City of Peterborough
- General Public:** Nancy De Guerre, Lauren Gilcrest
- Consultant:** Chris Visser and Mark Bietting– Golder and Associates  
Joe Ovcjak – Urban and Environmental Management  
Stephen Taziar - Genivar
- Regrets:** Councillor Shirley Eggleton

Chairman Reeve Nelson called the meeting to order at 7:05 pm.

Round table introductions were made.

**1. Approval of Minutes**

**Moved by:** Mayor Ayotte

**Seconded by:** Roy Craft

“That the Site Liaison Committee minutes of January 19, 2010 be approved as presented.”

**Carried**

**2. Business Arising from Minutes**

There was no business arising from the minutes.

**3. Formal Call for Committee Members - nominations**

**Moved by:** Mayor Ayotte

**Seconded by:** Steve St. Jean

“That the Site Liaison Committee defer the call for committee members until the January 18, 2011 meeting.”

**Carried**

**4. 2009 Annual Monitoring Report Overview – UEM and Genivar**

Joe Ovcjak provided a presentation on the 2009 Annual Monitoring Report. A copy of the presentation is attached to the minutes.

**5. 2009 Annual Consultant Peer Review Update – Golder Associates**

Mark Bietting provided a verbal presentation on the 2009 Annual Monitoring Report consultant review as well as a briefing on the status of the landfill site.

He noted that Golder reviewed the Annual Monitoring Report in it's draft stage, with their comments reflected in the final version of the report. He noted that the landfill site is very stable and operating as it is designed to. Any exceedences noted in 2008 sampling were not obvious in the 2009 sampling events.

## **6. Landfill Site Inspection – Golder Associates**

Chris Visser provided a verbal review of the site inspection that occurred on Monday, July 12, 2010. The site is neat and tidy, operating with minimal litter. Although some odour was observed during the January 2010 site inspection, there was basically no odour on site during the inspection. The only odour observed was garbage at the tipping face, which is to be expected.

**Moved by:** Mayor Ayotte

**Seconded by:** Steve St. Jean

"That the Site Liaison Committee receives the previous three presentations on the Annual Monitoring Report and the Landfill Site Inspection, as presented."

**Carried**

## **7. Waste Management Facility Operations Update**

Melanie Kawalec presented a report outlining the operational updates. A copy of the report is attached to the minutes.

**Moved by:** Councillor Eggleton

**Seconded by:** Deputy Reeve Heath

"That the Site Liaison Committee receive the written report as presented."

**Carried**

## **8. Other Business**

- a. Reeve Nelson requested an update on the airport expansion. It was noted that consultants are conducting studies for noise, wildlife and potential impact on the landfill operations. They are also looking at potential impacts of wildlife associated with the landfill as well as the local township. Mayor Ayotte advised that all approvals appear to be in place.
- b. A question arose on the landfill expansion potential. It was noted that the landfill has a life of approximately 13 years. Any further expansion will require an Environmental Assessment approval.
- c. Mr. Craft complained that the Cavan Depot trucks are cutting across Storell Road again rather than using the major roads. The County will follow up on this issue.
- d. Schedule for the widening of Bensfort Road was discussed, noting the removal of trees alongside the road. The County confirmed that the space was required for the widening of the road and the location of the new ditchline. Only the trees within the construction area were removed.

## **9. Next Meeting**

Next meeting is scheduled for January 18, 2011 at 7 p.m. at City Hall.

**10. Adjournment**

**Moved by:** Mayor Ayotte

**Seconded by:** Roy Craft

“That the meeting now be adjourned.”

**Carried**

The meeting adjourned at 8:05 pm.

# **LIAISON COMMITTEE MEETING JULY 13, 2010**



**GENIVAR**



URBAN &  
ENVIRONMENTAL  
MANAGEMENT INC.  
PROFESSIONAL CONSULTING SERVICES

# Presentation Contents

- 2009 Annual Report
  - a) site development
  - b) approvals status
  - c) operations and maintenance
  - d) leachate management system
  - d) landfill Gas System
  - f) surface and ground water monitoring
- Supporting Documents and Reports
- NFA Design and Construction Activities

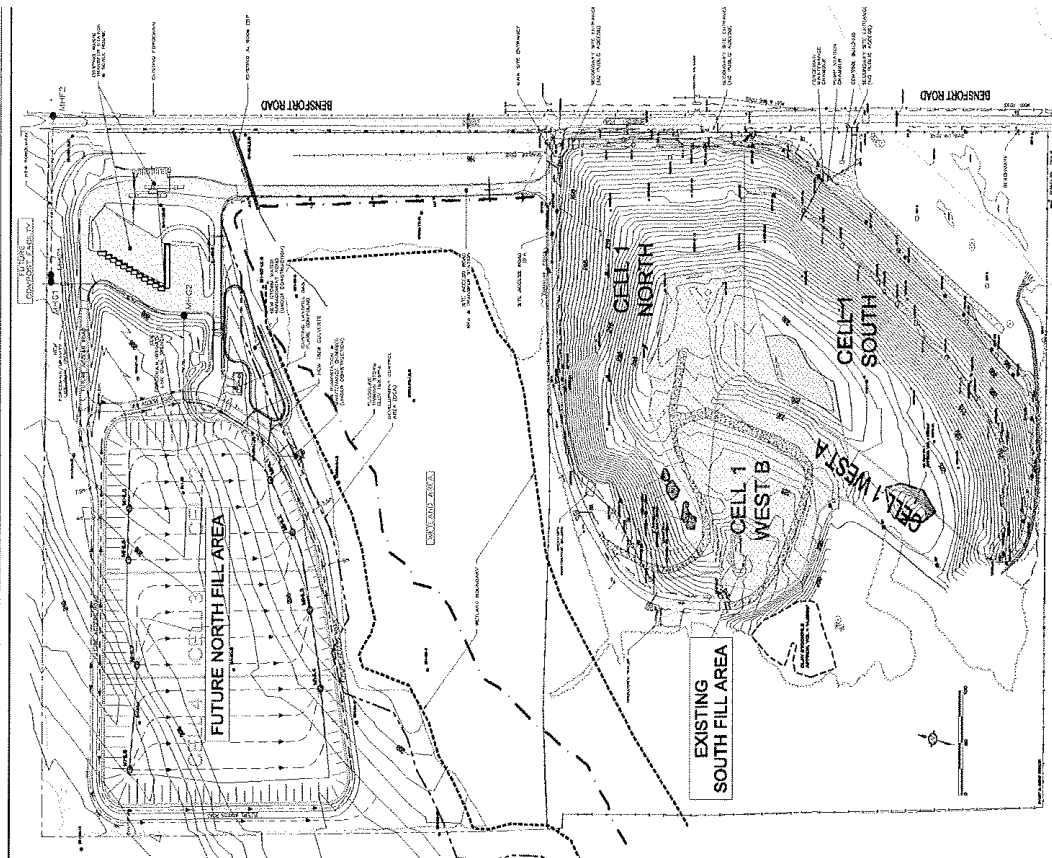

**LEGEND**

---	PROPERTY LINE
---	EXISTING FENCE LINE
---	EXISTING CONTOUR (MARS) (JANUARY 2009)
---	TREELINE
---	CELL LIMITS
---	EXISTING MANHOLE
---	STANDARD IRON BAR
---	UTILITY POLE
---	INCULC STANDPIPE
---	STANDPIPE
---	GAS PROBE
---	LANDFILL GAS EXTRACTION WELL
---	UNDERGROUND LATERAL LEACHATE HEADER
---	UNDERGROUND LATERAL LEACHATE CLEANOUT
---	UNDERGROUND CLEANOUT (UFG VALVE CHAMBER)
---	TIDE GIAN CLEANOUT
---	LEACHATE MONITOR
---	GROUNDWATER MONITOR
---	CORRODATED STEEL PIPE CULVERT
---	DRAINAGE SWALE
---	ASPHALT
---	GRAVEL
---	RIP RAP
---	2008 ACTIVE LANDFILLING (SFA)
---	FINAL COVER PLACED 2008 (SFA)
---	STOODPLES (SFA)
---	FLOODLINE TAININS STORM
---	WETLAND BOUNDARY
---	WETLAND BOUNDARY
---	DEVELOPMENT CONTROL AREA (CCA)

## SITE PLAN

# 2009 Annual Monitoring Report

## **SITE DEVELOPMENT**

1. In 2009 waste disposal continued in SFA.
2. 69,282 tonnes of waste placed.
3. Final cover placed on completed part of SFA.
4. 4.7 ha of 18.1 ha SFA not under final cover at end of 2009.
5. Topographic survey of SFA completed in January 2010.
6. January 2010 - SFA has 1.7 years capacity left
7. SFA at capacity - mid to late 2011.
8. Some waste in NFA in 2010 before SFA at capacity (liner protection)
9. Entire site has remaining capacity for at least 13 years.

# 2009 Annual Monitoring Report

## **APPROVAL STATUS**

- May 6, 2009 – EPA C of A amended to
  - (a) remove 19 ha parcel along Crowley Rd from Site,
  - (b) remove Condition 25.8 (status of search for long-term landfill
  - (c) LCS cleaning and video inspection frequency reduced to annual from semi annual.
- June 2008 PTTW received to permit NFA construction dewatering
- July 15, 2009 ORCA permit to construct stormwater system for NFA received
- July 30, 2009 OWRA approval to construct SWM pond and drainage works for NFA
- September 24, 2009 approval leachate management facilities for NFA.



# 2009 Annual Monitoring Report

## OPERATIONS AND MAINTENANCE

1. No violations of C of A conditions noted during inspections.
2. There were 487 offences recorded in 2009
3. 25 violation notices issued in 2009 related to loads containing over 10 percent recyclables.
4. On August 10, 2009 City Council adopted a resolution to increase tipping fees for asbestos from \$85 to \$200 per tonne.
5. On December 1, 2009 notice issued advising users that the tipping fee will increase from \$85 to \$90 per tonne effective January 1, 2010.

# 2009 Annual Monitoring Report

## LCS MONITORING, OPERATION AND MAINTENANCE

1. 79,928 cu m leachate and GW removed in 2009. (104,000 in 2008)
2. SFA Leachate generation will decline final cover placed.
3. When NFA opens, leachate quantities will increase.
4. In 2009 leachate quality generally met Sewer Use By-law criteria with exception of TKN. Historically TKN periodically exceeds By-law.
5. Leachate loading of BOD and TSS on WWTP is generally low and represents only a small portion of plant capacity.
6. Ammonia and TKN represent small influent load to WWTP.
7. LCS was flushed and inspected, clear of debris, structurally sound and working as designed.
8. forcemain pressure tested and within guideline of the OPSS.
9. Leachate seeps on upper east slope of SFA were repaired.
10. PS, flow meters, pumps inspected and maintained and functioning as designed

# 2009 Annual Monitoring Report

## GAS SYSTEM OPERATION AND MAINTENANCE

Maintenance of LFGS components undertaken in 2009 included:

- Repairs to Gas Well #3 due to well settling.
- Flare controls were maintained and replaced (thermocouples etc)
- Inspection of Gas Wells was performed in March 2009.
- Dillon completed a noise level reading on the flare in July 2009.
- Approx 5,484,000 cu m gas flared in 2009 (15,025 cu m/day)
- Annual Maintenance on the flare was performed.

# GROUNDWATER MONITORING ASSESSMENT

- Water quality effects from the landfill consist of leachate impacts and historical road salt effects to the east and north of the SFA, similar to previous monitoring. Leachate impacts are limited to overburden monitors immediately downgradient of the waste in these areas.
- During 2009, VOC's were detected in four leachate impacted monitors. Low concentrations of VOC's in other downgradient monitors, and within the NFA, may be naturally occurring and/or attributed to other sources.
- The Reasonable Use Policy limits that were exceeded are related to either road salt or natural groundwater quality variability at the site and are not attributed to landfill leachate. The performance monitoring program demonstrates that no contingency measures are required at this time.
- The NFA overburden and bedrock groundwater quality is representative of the natural baseline conditions, as no landfilling activities have taken place. The groundwater quality based on the 2009 results and previous monitoring indicates fresh overburden and bedrock groundwater, and brine influenced bedrock groundwater at two monitor locations, 86-I and 89-I.



## Supporting Documents

- NFA Stormwater Management Design Brief dated April 17, 2009 for OWRA and ORCA approval.
- NFA Design Brief for Leachate Management System dated June 2009 for OWRA approval.
- National Pollution Release Inventory (NPRI) Report June 1, 2009 – tracks release of GHG emissions and dust to atmosphere for Environment Canada.
- Landfill Gas Collection System Report (June 30, 2009) for existing SFA GCS and proposed additional wells for SFA as well as proposed NFA GCS (in concept only)

## **NFA CONSTRUCTION in 2009 and 2010**

- Stormwater pond, ditches, control chambers, emergency overflow spillway, inlet and outlet piping, staff gauge and associated swales.
- NFA pump station, meter chamber and electrical building.
- Forcemain between new PS and existing forcemain on Bensfort Road, connections and new chambers.
- Gravity sewer between PS and future compost pond on property to the north.
- Access roads, silt fence.
- Cell 2 liner, leachate management system, perimeter berms, access manholes, connection to PS – under construction

# LAYOUT

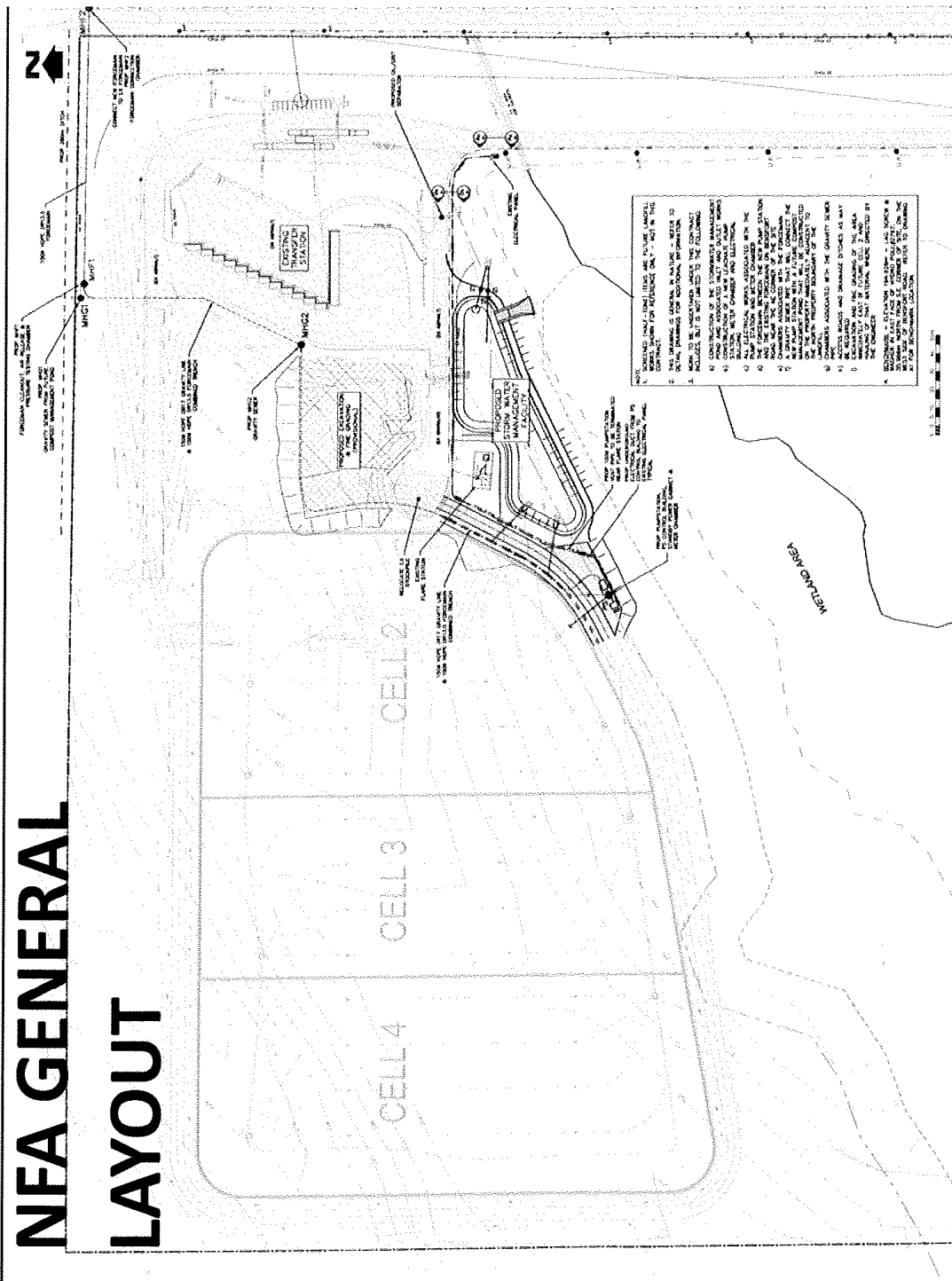



## **FUTURE ACTIVITIES**

- New gas wells (22 or more) in SFA after SFA under final cover (NFA gas wells progressively)
- Closure report for SFA in fall 2010
- Operation and waste placement NFA - fall 2010
- Construction of Gas Utilization Plant (2010/2011)
- Continued monitoring and site operations



City of  
Peterborough

## Report No. 7

---

**TO:** Site Liaison Committee

**FROM:** Melanie Kawalec, Manager of Waste Management

**DATE:** July 13, 2010

**SUBJECT:** Waste Management Facility Update

---

### 1. Operations Update

- a. Biosolids from the Wastewater Treatment Plant **stopped** coming to the landfill site as of April 2010. They are now hauled to Cardinal for land application.
- Received annual license to continue to take down gulls as a bird control method for the site.
  - b. Conducted odour-tracing project in May 2010, graphing the methane reading across the SFA, which are used as the primary tool for site maintenance and repairs.

### 2. Facility Complaints: January – June 2010

**January 19, 2010** - complaint received from Chris Johnston of MOE regarding a resident who complained of odour while driving by the site.

**Results:** Craig noted that the flare was closed down for the morning while repairs were conducted on gas wells. The flare was back up and running by the end of the day, once repairs were completed.

**March 11, 2010** – complaint received from Mrs. Reid of Cloverdale Line regarding odour.

**Results:** Some bio-solids had been set apart from the regular waste due to wet areas with the site. The biosolids had not yet been covered with household waste. Mrs. Reid was called on March 12<sup>th</sup> with a response.

### 3. Development Schedule

<u>Activity</u>	<u>Date</u>
Construction of NFA Utilities	Complete June 2010
Construction NFA Cell 2	Construction is ongoing and on schedule
Receive Waste in Cell 2	September 2010 – April 2010, or as required
Return to SFA until full	May 2010 – December 2010, or as required

**4. Landfill Gas Utilization Project**

PUI to hold a public meeting regarding the Peterborough Landfill Gas Generation project specifically a proposal to engage in a renewable Energy Project. Meeting scheduled for:

***Wednesday, July 21 from 4 until 7 p.m. at Stewart Hall Community Centre***

See handout provided at the meeting for project information.

**5. Landfill Properties Update**

- House at 1399 Cloverdale Line demolished Spring 2010;
- House at 1850 Storell rented as of June 15, 2010;
- House at 1385 Cloverdale Line rented as of August 1, 2010;
- All 8 houses are rented;
- All farmland is leased for crops or cattle to 4 area farmers.