



City of  
**Peterborough**

---

**To:** **Members of the Committee of the Whole**

**From:** **Malcolm Hunt, Director of Planning and Development Services**

**Meeting Date:** **July 25, 2016**

**Subject:** **Report PLPD16-052**  
**Partial Purchase of Property at 99 Lansdowne St. East**

---

## **Purpose**

A report to recommend the partial purchase of property at 99 Lansdowne St. East for the purpose of an asphalt multi-use trail.

## **Recommendation**

That Council approve the recommendation outlined in Report PLPD16-052 dated July 25, 2016, of the Director of Planning and Development Services as follows:

That a by-law be passed to authorize the partial purchase of the property at 99 Lansdowne St East, described as Part 1 on Reference Plan 45R-16183 (Part of PIN 28097-0265) for \$35,000.00, plus land transfer tax of \$175.00.

## **Budget and Financial Implications**

These purchases will be funded from the Utility Services Department "City's Provision of Sidewalks Policy Number MS08-7750 and Sidewalk Implementation Procedure for Existing Streets" (2016 Capital Budget Reference Number 5-5.01 (Page 154)).

## Background

This partial taking of property is required to complete the City's Provision of Sidewalks and Sidewalk Implementation Procedure for Existing Streets, This property is a large residential lot with a single family dwelling. The City is constructing new sidewalks and a portion of multi-use trail. The width of the widening is approximately 3 metres by 85.98 meters for a total taking of 257.94 sq meters.

The taking was appraised in March 2016 by McLean, Simon & Associates at an ascribed value of \$35,000.00 (the purchase price)

As is the case with all widening projects, the City will be responsible to restore the property (See Appendix 'A'), which in this case includes the replacement of the entrances and installation of a new fence. The City will be paying the vendor's reasonable legal fees for this transaction.

Submitted by,

---

Malcolm Hunt, MCIP RPP  
Director of Planning and Development Services

---

Stephen Burman,  
Real Estate and Development  
Manager

### Contact Name:

Stephen Burman  
Phone – 705-742-7777 Ext. 1484  
Fax – 705-742-5218  
E-Mail – sburman@peterborough.ca

### Attachments:

Appendix A: Property Plan  
Appendix B: Registered Plan

## Appendix "A" - Property Plan

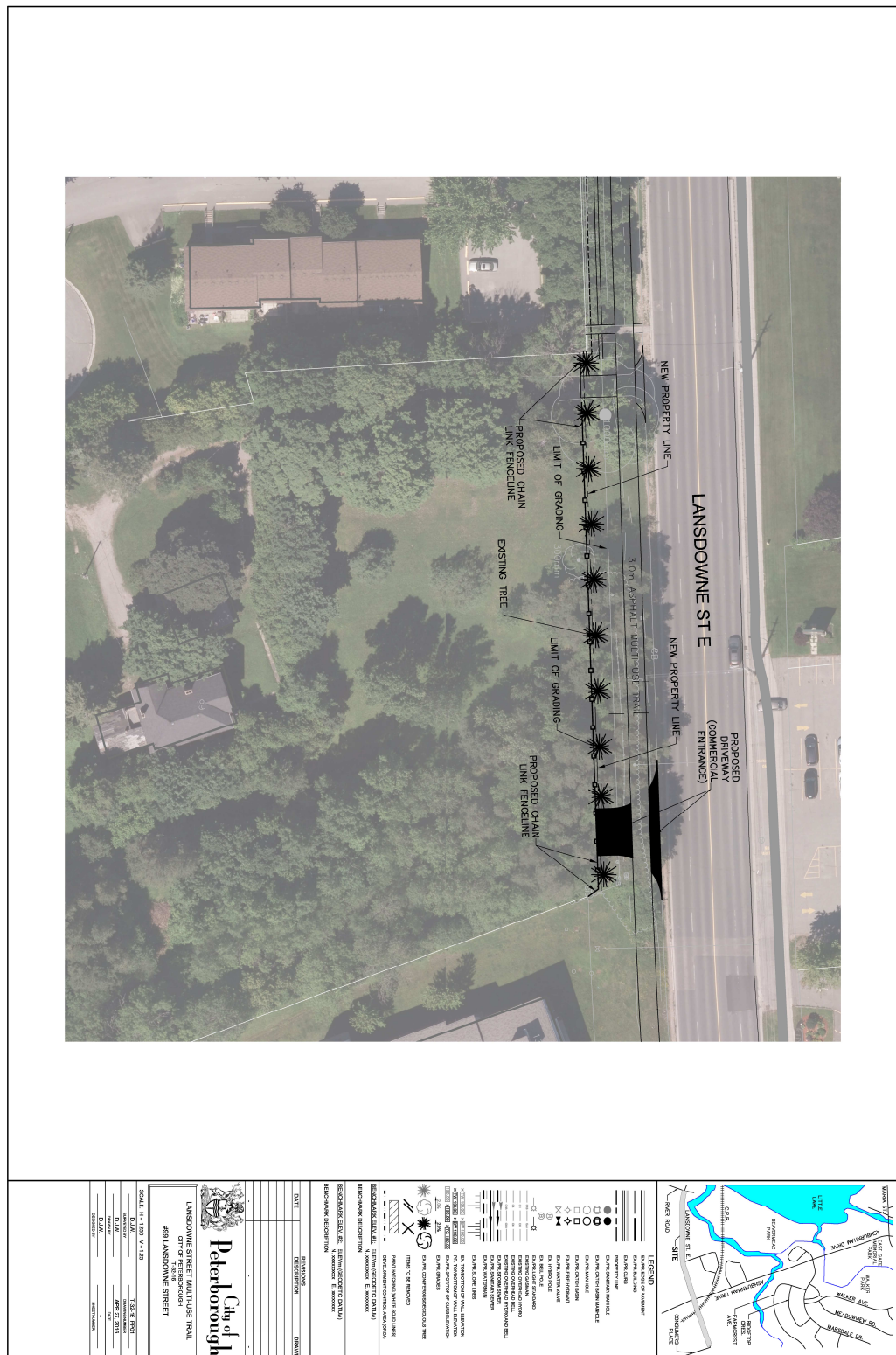

## Appendix “B” - Registered Plan

